

# GROMMET SETS

March 2009

## Grommets, Sleeves, and Washers for use with the Plant Water Status Console

(Figure 1) - Complete G4 Grommet kit (3019G4K3) shown here

SEALING SLEEVES	STEM GROMMETS (use with petioles)	LEAF GROMMETS (use with leaves or grasses)	SUPPORT WASHERS
 3018G4DBLKPKG05 1/2"OD, BLANK	 3019G4DBLKPK5 BLANK	 3019G4UTE01PK5 1/16"WIDE x 1/4" ELIPSE	 3020G4BLKPK5 BLANK
 3018G4D062PKG05 1/2"OD, 1/16"DIAM. HOLE	 3019G4D062PK5 1/16"DIAM. HOLE	 3019G4UTS01PK5 .050"WIDE x 1/2" SLOT	 3020G4D140PKG5 9/64" DIAM. HOLE
 3018G4D125PKG05 1/2"OD, 1/8"DIAM. HOLE	 3019G4D093PK5 3/32"DIAM. HOLE	 3019G4UTE02PK5 1/8"WIDE x 1/2" ELIPSE	 3020G4D250PK5 1/4" DIAM. HOLE
 3018G4D187PKG05 1/2"OD, 3/16"DIAM. HOLE	 3019G4D125PK5 1/8"DIAM. HOLE	 3019G4UTA01PK5 1/8"WIDE x 1/2" ARC	 3020G4D375PK5 3/8" DIAM. HOLE
 3018G4D250PKG05 1/2"OD, 1/4"DIAM. HOLE	 3019G4D187PK5 3/16"DIAM. HOLE		 3020G4D500PK5 1/2" DIAM. HOLE
	 3019G4D25PK5 1/4"DIAM. HOLE		 3020G4UTE01PK5 1/16"WIDE x 1/2" SLOT
	 3019G4D375PK5 3/8"DIAM. HOLE		 3020G4UTE02PK5 1/8"WIDE x 1/2" SLOT
	 3019G4D500PK5 1/2"DIAM. HOLE		



(Figure 2) - G4 Specimen Holder

### G4 Specimen Holder (General Purpose)

The G4 Specimen Holder is a General Purpose Holder. It can be set up to accept round petioles from 1/32 inch diameter to 1/2 inch diameter; for short petioles from 1 cm long; and for blade-type leaves up to 1/2 inch wide and on midvein of larger leaves. Above, (Figure 1) are the range of Grommets, Sealing Sleeves, and Support Washers used with the Plant Water Status Console using the G4 Specimen Holder.

#### Grommets (second row from the top)

Starting from the left, the first Grommet, a solid Grommet (no hole), can be used for testing the system for leakage or to make your own Grommet. The next five Grommets are used for testing petioles from the size of pine needles up to thick leaves, selection based on the size of the petiole to be tested. The last item in the row, with the very large hole, is a Grommet that accepts the sealing sleeves shown in the very top top row.

---

## G4 Specimen Holder (cont.)

Rather than disassembling the specimen holder for each test, the sealing sleeves can be quickly taken in and out of the Grommet for fast sampling.

The Grommets with slits in them (third row, Fig.1) are usually used for testing large leaves or grass blades.

The G4 Series Brass Support Washers are used in conjunction with the Grommets to protect the Grommets when the knob is tightened, thereby providing equal pressure over the entire surface of the Grommet. The Support Washers also prevent the Grommet from being pushed out of the specimen holder when pressurized.

**NOTE: The G4 Series Sealing Sleeves, Grommets and Washers can only be used with the G4 Specimen Holder.**

## G2 Specimen Holder (used for Blade-type Leaves)

(Figure 3) - G2 Series Complete Grommet Kit (3017G2K1)



(Figure 4) - G2 Series Specimen Holder

The G2 Specimen Holder is used specifically for blade-type leaves up to 1 inch in width. (Fig. 3) above shows the G2 Series Grommets and Support Washers.

The items shown in the left row of (Fig. 3), are called Grommets. They are for use with broad leaves or grasses; and the brass items shown at the bottom of the photograph are called Support Washers.

**NOTE: The 3017G2 Series Grommets can only be used with the G2 Specimen Holder.**

## PARTS and KITS

PART NUMBER	DESCRIPTION
<b>G4 Series Sealing Sleeves</b> <i>(For round petioles from 1/32" (0.79 mm) diam. to 1/2" (12.7 mm) diam.)</i>	
3018G4DBLKPKG05	QUICK-SEAL SEALING SLEEVE, BLANK - NO HOLE, 30 shore, white
3018G4D062PKG05	QUICK-SEAL SEALING SLEEVE, .062 (1.57mm) Hole Dia. Seal, 5ea., 30 shore, white
3018G4D125PKG05	QUICK-SEAL SEALING SLEEVE, .125 (3.18mm) Hole Dia. Seal, 5ea., 30 shore, white
3018G4D187PKG05	QUICK-SEAL SEALING SLEEVE, .187 (4.76mm) Hole Dia. Seal, 5ea., 30 shore, white
3018G4D250PKG05	QUICK- SEAL SEALING SLEEVE, 250 (6.35mm) Hole Dia. Seal, 5ea., 30 shore, white
3018G4DBLKPKG05	QUICK-SEAL SEALING SLEEVE, BLANK - NO HOLE, 30 shore, white
3019G4D500PKG05	QUICK-SEAL COMPRESSING GROMMET, .500 in ID, 5ea., 30 shore, white
<b>G4 Series Stem Grommets</b> <i>(For leaf specimens with short petioles 1 cm long or somewhat less)</i>	
3019G4DBLKPK5	COMPRESSION STEM GROMMET, Saucer Type, BLANK, 5ea., 30 shore, white
3019G4D062PK5	COMPRESSION STEM GROMMET, Saucer Type, 062 in.(1.57 mm) dia. Seal, 5ea., 30 shore, white
3019G4D093PK5	COMPRESSION STEM GROMMET, Saucer Type, .093 in.(2.38 mm) dia. Seal, 5ea., 30 shore, white
3019G4D125PK5	COMPRESSION STEM GROMMET, Saucer Type, .125 in.(3.16 mm) dia. Seal, 5ea., 30 shore, white
3019G4D187PK5	COMPRESSION STEM GROMMET, Saucer Type, .187 in.(4.76 mm) dia. Seal, 5ea., 30 shore, white
3019G4D187PK5	COMPRESSION STEM GROMMET, Saucer Type, .250 in.(6.35 mm) dia. Seal, 5ea., 30 shore, white
3019G4D375PK5	COMPRESSION STEM GROMMET, Saucer Type, .375 in.(9.52 mm) dia. Seal, 5ea., 30 shore, white
3019G4D500PK5	COMPRESSION STEM GROMMET, Saucer Type, .500 in.(1.27 cm) dia. Seal, 5ea., 30 shore, white
3017G2WBLKPKG05	LEAF PUCK GROMMET, BLANK , 5ea., 30 shore, white
3017G2WRZRPKG05	LEAF PUCK GROMMET, RAZOR CUT, 5ea., 30 shore, white
3017G2W050PKG05	LEAF PUCK GROMMET, .050 (1.27mm) SLOT, 5ea., 30 shore, white
3017G2W090PKG05	LEAFPUCK GROMMET, .090 (2.29mm) SLOT, 5ea., 30 shore, white

(Figure .

## PARTS and KITS (CONT.)

<b>G4 Series Brass Support Washers</b>	
3021G2-001K1	G2 Series Brass Washer, 1/16", Slot (5 Pack)
3020G4BLKPK5	BRASS SUPPORT FOR 3019G4DBLK GROMMETS, Pkg 5
3020G4D250PK5	BRASS SUPPORT FOR 3019G4D250 GROMMETS, Pkg 5
3020G4UTE01PK5	BRASS SUPPORT FOR 3019G4UTE01 GROMMETS, Pkg 5
3020G4UTE02PK5	BRASS SUPPORT FOR 3019G4UTE02 GROMMETS, Pkg 5
3020G4D375PK5	BRASS SUPPORT FOR 3019G4D375 GROMMETS, Pkg 5
3020G4D500PK5	BRASS SUPPORT FOR 3019G4D500 GROMMETS, Pkg 5
<b>G2 Series Grommets (Designed to accept blade-type leaves up to 1"(25.4 mm) in width)</b>	
3019G4UTE01PK5	SPECIALITY COMPRESSION STEM GROMMET, Saucer, .062" x .125", Eye Type 01 seal, 5ea., 30 shore,
3019G4UTE02PK5	SPECIALITY COMPRESSION STEM GROMMET, Saucer, .125" x .500" Eye Type 02 seal, 5ea., 30 shore, white
3019G4UTA01PK5	SPECIALITY COMPRESSION STEM GROMMET, Saucer, .125" x .500" Arc Type 01 seal, 5ea., 30 shore, white
3019G4UTS01PK5	SPECIALITY COMPRESSION STEM GROMMET, Saucer, .050" x .500" Slot Type 01 seal, 5ea., 30 shore, white
<b>SPECIAL KITS</b>	
3017G2K1	G2 SERIES COMPLETE GROMMET KIT FOR G2 SPECIMEN HOLDER
3018G4K1	QUICK-SEAL, FULL SET, includes all sealing sleeves, compressing grommet and support washers
3018G4K2	QUICK SEAL, SLEEVE SET, sleeves only, no compression grommet, or support washer
3018G4K3	QUICK-SEAL, SLEEVE SET WITH COMPRESSION GROMMET, less support washers
3018G4K4	QUICK SEAL, SUPPORT WASHER SET, a set D250, D140, DBLK support washers
3019G4DK1	COMPRESSION STEM GROMMET SET, 1.ea. all "D" round holes, Saucer Type
3019G4UK1	SPECIALITY COMPRESSION STEM GROMMET "UT" KIT, all arcs/ellipses, Saucer Type, Complete SET
3020G4DK1	COMPLETE SUPPORT SET for all 3019G4D round hole series
3020G4UTK1	COMPLETE 3019G4UT SUPPORT SET, for all specialized grommets.

# REPLACEMENT PARTS / 3015G4 SPECIMEN HOLDER ASSEMBLY

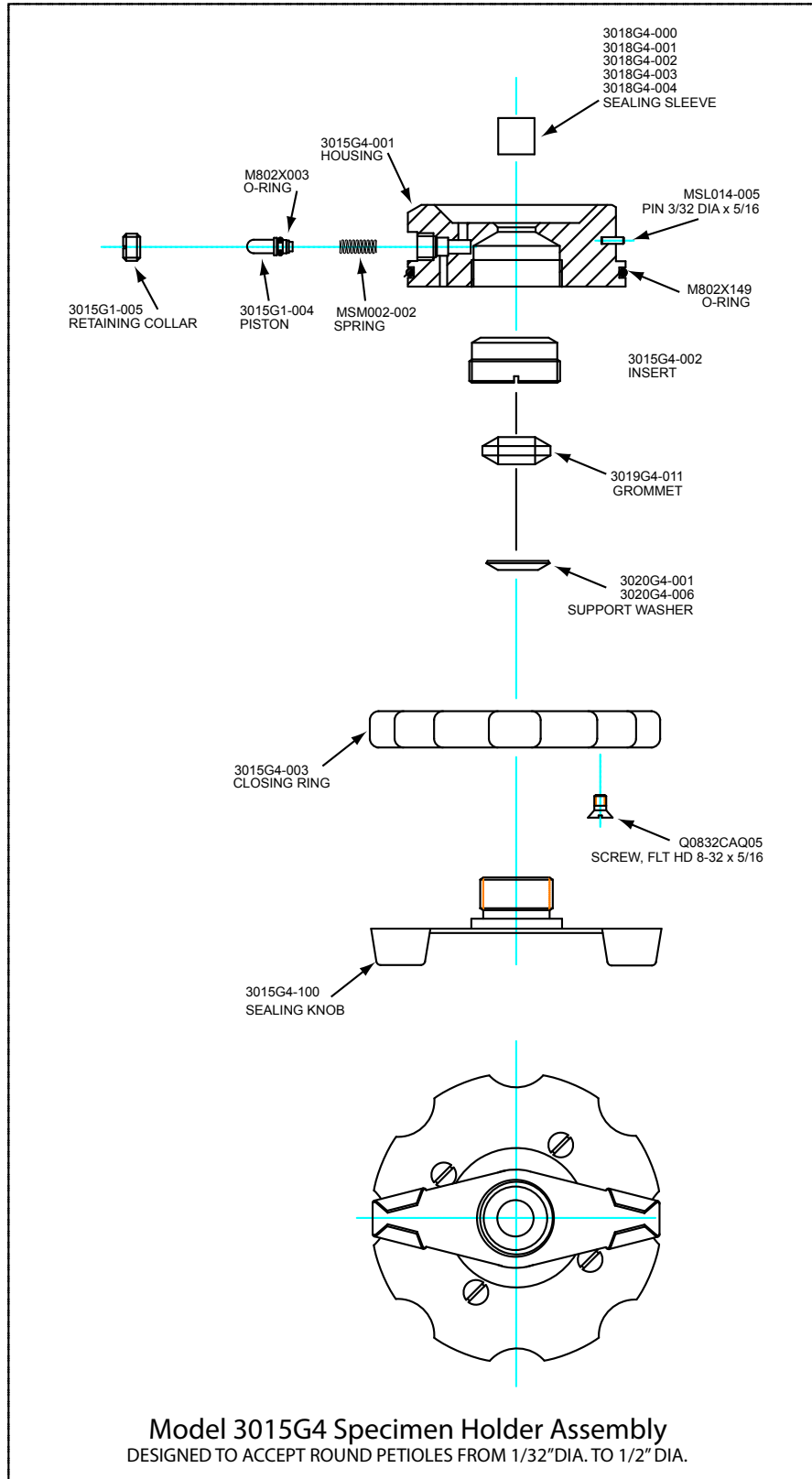

**REPLACEMENT PARTS / 3015G2 SPECIMEN HOLDER ASSEMBLY**

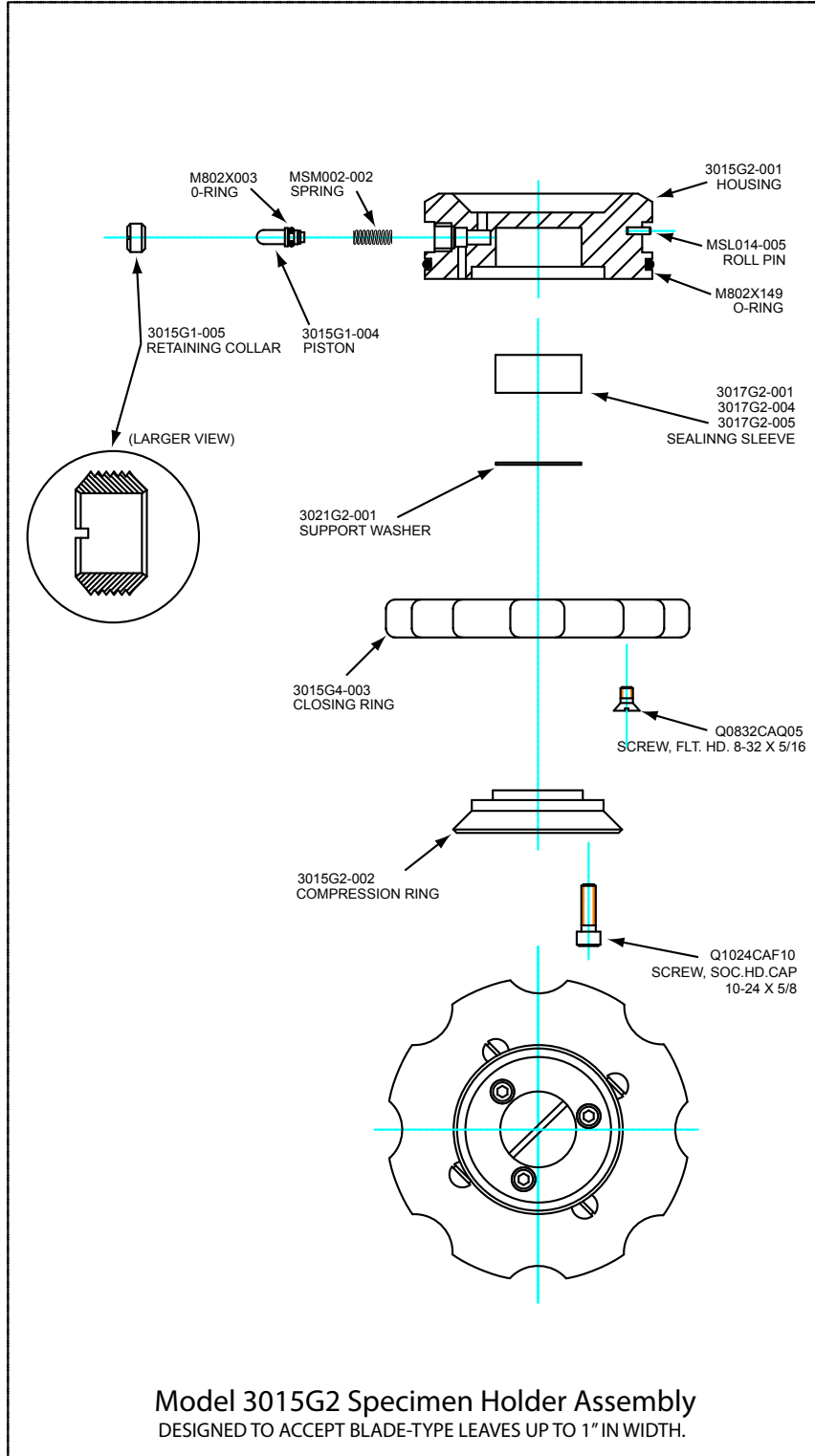

---

**With dealers throughout the world,  
you have convenience of purchase and assurance  
of after-sales service.**

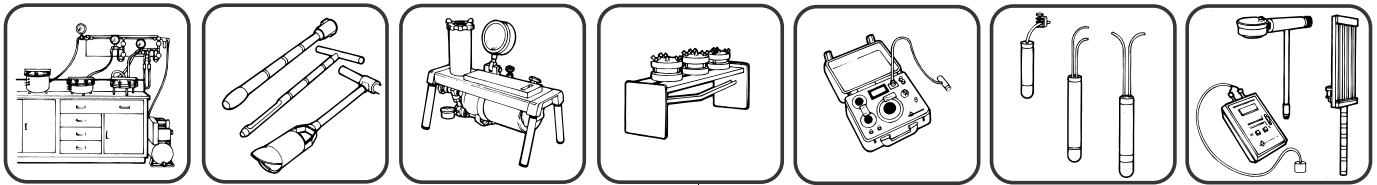

© COPYRIGHT 2008 ALL RIGHTS RESERVED ~ GROMMETS